

EXPLANATION: This Ordinance amends Chapter XVI entitled "Zoning" by amending Section 16-3 entitled "Official Zoning Map" and Interpretation" to change the zoning district classification on the Official Zoning Map from R-65 Residential and R-40 Rural Residential to CR 130/65 Environmental Critical Rural Residential District for certain properties.

**TOWNSHIP OF WARREN  
ORDINANCE NO. 16-18**

**AN ORDINANCE OF THE TOWNSHIP OF WARREN, COUNTY OF SOMERSET,  
STATE OF NEW JERSEY, TO AMEND SECTION 16-3 ENTITLED "OFFICIAL  
ZONING MAP AND INTERPRETATION" OF CHAPTER XVI ENTITLED  
"ZONING" OF THE REVISED GENERAL ORDINANCES OF THE TOWNSHIP OF  
WARREN**

**BE IT ORDAINED** by the Mayor and Township Committee of the Township of Warren, in the County of Somerset and State of New Jersey as follows:

**SECTION 1.** Subsection 16-3.1 entitled "Official Zoning Map" of Section 16-3 entitled "Official Zoning Map and Interpretation" of Chapter XVI entitled "Zoning" of The Revised General Ordinances of the Township of Warren is amended as follows:

- A. Change the zoning district classification on the official zoning map from R-65 Residential and R-40 Rural Residential to CR 130/65 Environmental Critical Rural Residential District for the following properties:
1. Block 12 Lots 21.01
  2. Block 22 Lot 1.03

The boundaries of the rezoned area are indicated on Exhibit A attached to this ordinance.

**SECTION 2.** All other ordinances, part of ordinances, or other local requirements that are inconsistent or in conflict with this ordinance are hereby repealed to the extent of any inconsistency or conflict, and the provisions of this ordinance apply.

**SECTION 3.** Notwithstanding that any provision of this Ordinance is held to be invalid or unconstitutional by a court of competent jurisdiction, all remaining provisions of the Ordinance shall continue to be of full force and effect.

**SECTION 4.** This ordinance shall take effect immediately upon (1) adoption; (2) publication in accordance with the laws of the State of New Jersey; and (3) filing of the final form of adopted ordinance by the Clerk with the Somerset County Planning Board pursuant to N.J.S.A. 40:55D-16.

ATTEST:

WARREN TOWNSHIP COMMITTEE

  
\_\_\_\_\_  
Cathy Reese, RMC  
Township Clerk

  
\_\_\_\_\_  
George K. Lazo, Mayor

INTRODUCED            September 8, 2016  
  
ADOPTED                October 27, 2016  
  
EFFECTIVE              November 3, 2016

Handwritten signature or initials in blue ink.

**EXHIBIT  
"A"**

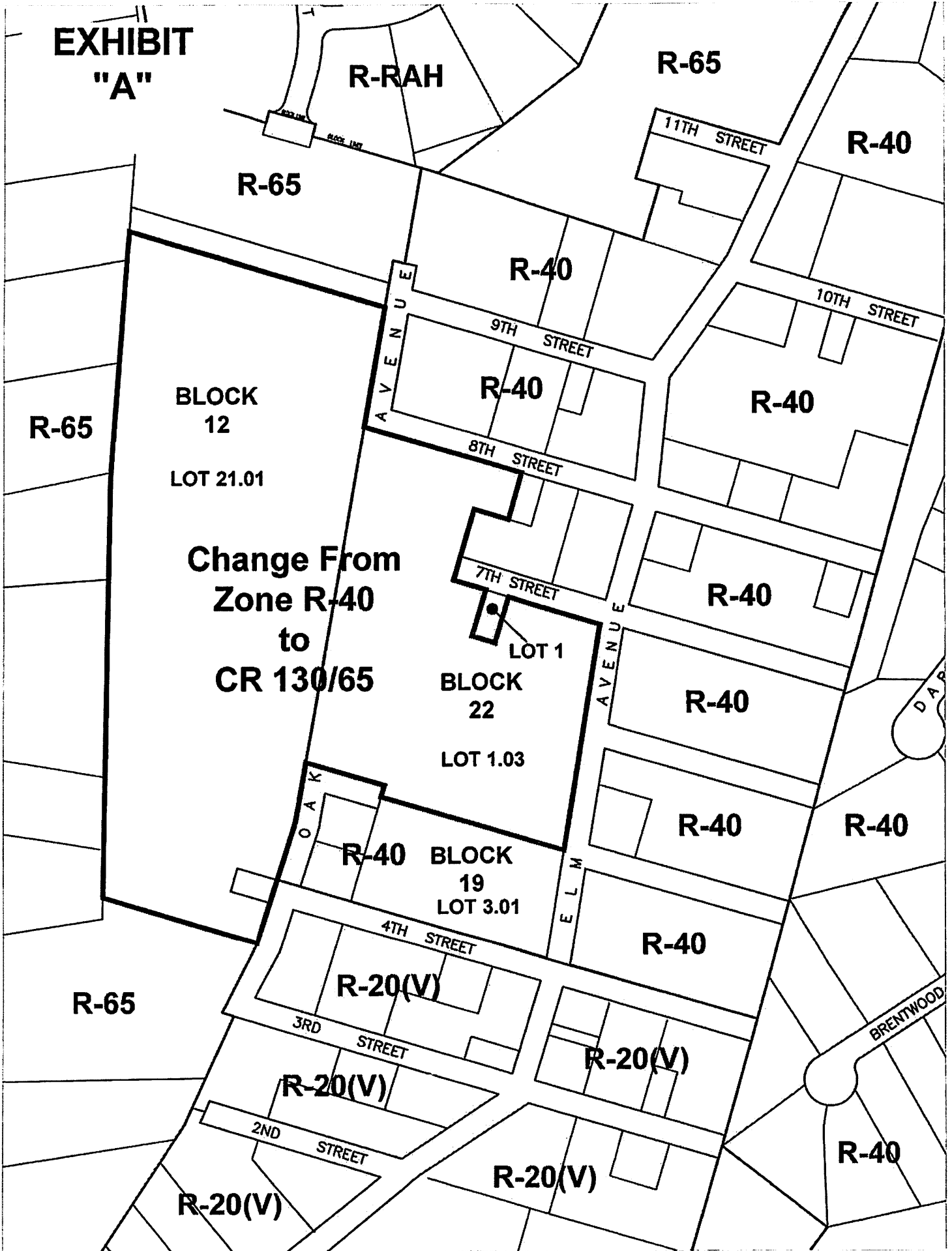

**Change From  
Zone R-40  
to  
CR 130/65**

BLOCK  
12  
LOT 21.01

LOT 1  
BLOCK  
22  
LOT 1.03

BLOCK  
19  
LOT 3.01

R-40

R-20(V)

R-20(V)

R-20(V)

R-20(V)

R-20(V)

R-40

R-40

R-40

R-40

R-40

R-40

R-40

R-65

R-65

R-RAH

R-40

R-65

R-65

R-40

R-40

BRENTWOOD

OAK

ELM AVENUE

AVENUE

AVENUE

11TH STREET

10TH STREET

9TH STREET

8TH STREET

7TH STREET

4TH STREET

3RD STREET

2ND STREET

BLADE UNIT

BLADE UNIT